

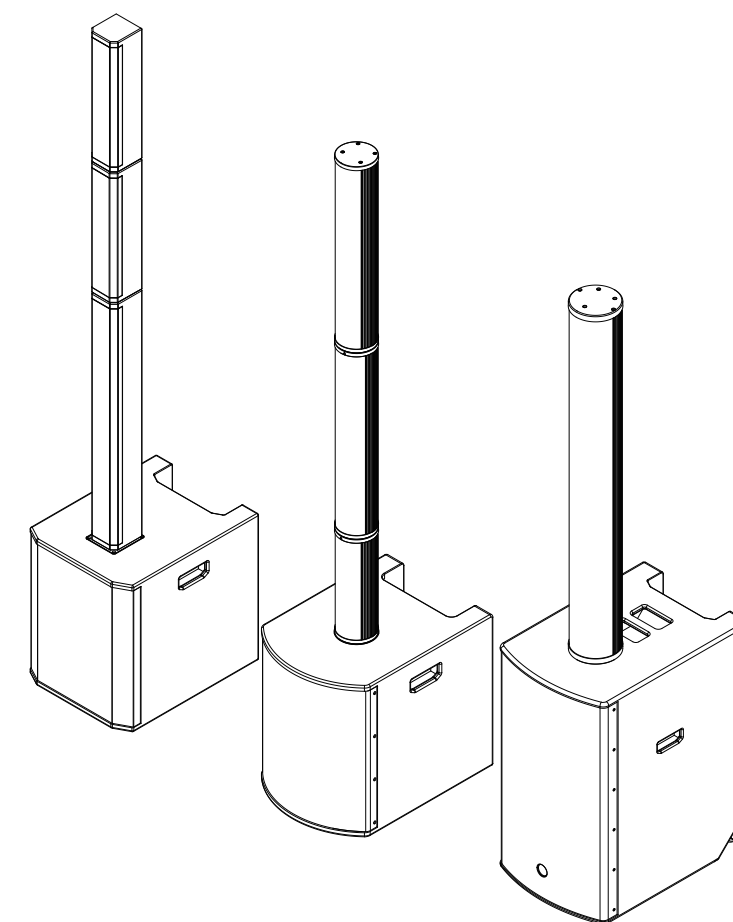

User's Manual

**AXV42.12 SYSTEM
AXV62.15 SYSTEM
AXV24.215 SYSTEM**



Important Safety Instructions



TO REDUCE THE RISK OF ELECTRIC SHOCK PLEASE DO NOT REMOVE THE COVER OR THE BACK PANEL OF THIS EQUIPMENT. THERE ARE NO PARTS NEEDED BY USER INSIDE THE EQUIPMENT. FOR SERVICE, PLEASE CONTACT QUALIFIED SERVICE CENTERS.

This symbol, wherever used, alerts you to the presence of un-insulated and dangerous voltages in the product enclosure. These are voltages that may be sufficient to constitute the risk of electric shock or death.

This symbol, wherever used, alerts you to important operating and maintenance instructions. Please read.

Protective Ground Terminal

AC mains (Alternating Current)

Hazardous Live Terminal

ON: Denotes the product is turned on.

OFF: Denotes the product is turned off.

CAUTION

Describes precautions that should be observed to prevent damage to the product.

1. Read this Manual carefully before operation.
2. Keep this Manual in a safe place.
3. Be aware of all warnings reported with this symbol.
4. Keep this Equipment away from water and moisture.
5. Clean it only with dry cloth. Do not use solvent or other chemicals.
6. Do not damp or cover any cooling opening. Install the equipment only in accordance with the Manufacturer's instructions.
7. Power Cords are designed for your safety. Do not remove Ground connections! If the plug does not fit your AC outlet, seek advice from a qualified electrician. Protect the power cord and plug from any physical stress to avoid risk of electric shock. Do not place heavy objects on the power. This could cause electric shock or fire.
8. Unplug this equipment when unused for long periods of time or during a storm.
9. Refer all service to qualified service personnel only. Do not perform any servicing other than those instructions contained within the User's Manual.
10. To prevent fire and damage to the product, use only the recommended fuse type as indicated in this manual. Do not short-circuit the fuse holder. Before replacing the fuse, make sure that the product is OFF and disconnected from the AC outlet.

WARNING

To reduce the risk of electric shock and fire, do not expose this equipment to moisture or rain.

Dispose of this product should not be placed in municipal waste and should be separate collection.

11. Move this Equipment only with a cart, stand, tripod, or bracket, specified by the manufacturer, or sold with the Equipment. When a cart is used, use caution when moving the cart / equipment combination to avoid possible injury from tip-over.



12. Permanent hearing loss may be caused by exposure to extremely high noise levels. The US. Government's Occupational Safety and Health Administration (OSHA) has specified the permissible exposure to noise level. These are shown in the following chart:

Hours x day	SPL	Example
8	90	Small gig
6	92	Train
4	95	Subway train
3	97	High level desktop monitors
2	100	Classic music concert
1.5	102	
1	105	
0.5	110	
0.25 or less	115	Rock Concert

According to OSHA, an exposure to high SPL in excess of these limits may result in the loss of heat. To avoid the potential damage of heat, it is recommended that Personnel exposed to equipment capable of generating high SPL use hearing protection while such equipment is under operation.

The apparatus shall be connected to a mains socket outlet with a protective earthing connection.

The mains plug or an appliance coupler is used as the disconnect device, the disconnect device shall remain readily operable.

Table of Contents

1. INTRODUCTION.....	4
2. Installation Tips.....	4
3. USEFULL DATA.....	4
4. QUICK START.....	5
5. CONNECT MANNER.....	6
6. BACK PANEL DESCRIPTION.....	9
7. CONNECTION PLATE SYSTEM.....	13
8. WIRE CONNECTIONS.....	14
9. TECHNICAL SPECIFICATIONS.....	15

Introduction

The new cabinets have been designed to provide a cost effective high grade solution while maintaining high quality cabinet construction and optimum components.

Our Professional Audio Products are designed and tested by a highly qualified engineering team with more than 20 years of experience. Great care is placed in delivering products with excellent performance, specifications and dependable reliability. Also great emphasis is placed in creating and bringing to market products that can fill multiple applications and also offer customers exceptional value.

Every audio product is strictly tested and complied to very strict standards.

Installation Tips

- Speakers should be placed in a position that allows for unobstructed sound projection. In many instances it is beneficial for speakers to elevate on tripod stands to achieve maximum dispersion and reach. Consider speaker stand or equivalent to raise speakers.
- Using quality cables ensure best possible sound. Consider using 16 or 14 gauge cables or equivalent.
- For best results match the speakers to a good amplifier that matches the wattage and impedance of your speakers. Proper amplification power results in good quality audio and longer component life. Check out.
- Avoid pointing microphone directly at an amplified speaker otherwise could cause feedback possible damaging speaker components and your hearing.

Enjoy the sound!

Usefull Data

Please write your serial number here for future reference.

Serial Number:

Date of Purchase:

Purchased at:

Technical Specifications

AXV24.215 SYSTEM: AXV24.215 SUB+AXV24.215 SAT

AXV24.215 System	
Frequency Response	35Hz – 20KHz (-10dB)
Total Amplifier Power	2000W Continuous / 4000W Program / 8000W Peak Class D @ 4 Ohms
Maximum SPL@1M	134dB
Crossover Frequency	200Hz
Dispersion(-6dB)	130°Horizontal
Dimensions(WxHxD)	460 x 2010 x 676mm (18.11" x 79.13" x 26.6")
Net Weight	50.15Kg (110.56 lbs)
AXV24.215 SUB	
System Type	2 x 15" Active Subwoofer Speaker Cabinet
Frequency Response(-6dB)	35Hz – 180Hz
Total Amplifier Power	2000 W Continuous / 4000W Program/8000W Peak Class D @ 4 Ohms
Amplifier, Subwoofer	1000 W Continuous / 2000W Program/4000W Peak Class D @ 4 Ohms
Amplifier, Satellite	1000 W Continuous / 2000W Program/4000W Peak Class D @ 4 Ohms
DSP Presets Modes	LIVE / Music / SPEECH / DJ
Electronic Protections	Over heat Protection/Short Circuit Protection/Digital Compressor
Cooling	Temperature-controlled fan
Connections	Input: 4 x Combo-XLR&1/4", 1 x RCA In L&R, 1 x 3.5 Stereo Jack, Output: 1 x XLR Thru&Mixout, 1 x Speakon Satellite
External Controls	Volume Control/Switch for Input sens/Swtich for mode selector/Power ON with Green LED/Limiter with Red LED/Ground Lift/OLED DSP Display and Control /IP Control/MP3 and BT(option)
Power Supply	115V/230V ~50/60Hz Switchable
Enclosure Construction	Plywood Cabinet, Resistant Black Paint, Metal Grille with Foam, Rubber Feet, Integrated side handles
Mounting	Smart Mounting and Connection
Dimensions(WxHxD)	460 x 830 x 676mm (18.11" x 32.67" x 26.6")
Net Weight	40.47Kg (89.22 lbs)
AXV24.215 SAT	
System Type	24*3" Passive Speaker System
Output Power	480W Continuous, 960W Program, 1920W Peak
Sensitivity (1W/1M)	99dB
Frequency Response(-6dB)	150Hz-20kHz
Impedance	4 ohms
Transducer Low	3" Neodymium Fullrange Speaker, 0.8" (20.4mm) Voice Coil
Enclosure Construction	Aluminium Cabinet, Metal Grille, Resistant Paint
Connector	2 Pin smart connection
Dimensions(WxHxD)	φ167 x 1170mm(φ6.57" x 46.06")
Net Weight	9.7Kg (21.38 lbs)

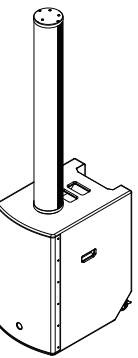

Technical Specifications

AXV62.15 SYSTEM: AXV62.15+AX POLE+AXV62BM+AXV62TP

AXV62.15 System	
Frequency Response	40Hz – 20KHz (-10dB)
Total Amplifier Power	1000W Continuous/2000W Program/4000W Peak Class D @ 4 Ohms
Maximum SPL@1M	128dB
Crossover Frequency	220Hz
Dispersion(-6dB)	120°Horizontal
Dimensions(WxHxD)	440 x 2015 x 640mm (17.32" x 79.33" x 25.20")
Net Weight	37.81Kg (83.35 lbs)
AXV15SA	
System Type	15" Active Subwoofer Speaker Cabinet
Frequency Response(-6dB)	40Hz – 210Hz
Total Amplifier Power	1000W Continuous/2000W Program/4000W Peak Class D @ 4 Ohms
Amplifier, Subwoofer	500W Continuous/1000W Program/2000W Peak Class D @ 4 Ohms
Amplifier, Satellite	500W Continuous/1000W Program/2000W Peak Class D @ 4 Ohms
DSP Presets Modes	LIVE / Music / SPEECH / DJ
Electronic Protections	Over heat Protection/Short Circuit Protection/Digital Compressor
Cooling	Temperature-controlled fan
Connections	Input: 4 x Combo-XLR&1/4", 1 x RCA In L&R, 1 x 3.5 Stereo Jack, Output: 1 x XLR Thru&Mixout, 1 x Speakon Satellite
External Controls	Volume Control/Switch for Input sens/Swtich for mode selector/Power ON with Green LED/ Limiter with Red LED/Ground Lift/OLED DSP Display and Control /IP Control/MP3 and BT(option)
Power Supply	115V/230V ~50/60Hz Switchable
Enclosure Construction	Plywood Cabinet, Resistant Black Paint, Metal Grille with Foam, Rubber Feet, Integrated side handles
Mounting	Smart Mounting and Connection
Dimensions(WxHxD)	440 x 520.5 x 640mm (17.32" x 20.49" x 25.20")
Net Weight	26.1Kg (57.54 lbs)
AXV Pole	
Enclosure Construction	Aluminium Cabinet, Metal Grille, Resistant Paint
Connector	2 x Electronic Adapter - 1 x Input Connector for Sub & Another with Input Connector for Satellite
Dimensions(WxHxD)	φ112.5 x 354mm(φ4.43" x 13.94")
Net Weight	1.36Kg (3.0 lbs)
AXV 62BM	
System Type	6 x 3.5" Passive Speaker System
Output Power	180W Continuous, 360W Program, 720W Peak
Sensitivity (1W/1M)	96dB
Frequency Response(-6dB)	150Hz-20kHz
Impedance	16 ohms
Transducer Low	3.5" Woofer , 1.0" (25.4mm) Voice Coil
Rotation	360 Degree Mechanical Adjustment
Enclosure Construction	Aluminium Cabinet, Metal Grille, Resistant Paint
Connector	2 x Electronic Adapter - 1 x Input Connector for AX Pole & Another with Input Connector for AXV62TP
Dimensions(WxHxD)	φ112.5 x 609.7mm(φ4.43" x 24.0")
Net Weight	5.2Kg (11.46 lbs)
AXV 62TP	
System Type	6 x 3.5" Passive Speaker System
Output Power	180W Continuous, 360W Program, 720W Peak
Sensitivity (1W/1M)	96dB
Frequency Response(-6dB)	150Hz-20kHz
Impedance	16 ohms
Transducer Low	3.5" Woofer , 1.0" (25.4mm) Voice Coil
Rotation	360 Degree Mechanical Adjustment
Enclosure Construction	Aluminium Cabinet, Metal Grille, Resistant Paint
Connector	2 Pin smart connection
Dimensions(WxHxD)	φ112.5 x 583.2mm(φ4.43" x 22.96")
Net Weight	5.15Kg (11.35 lbs)

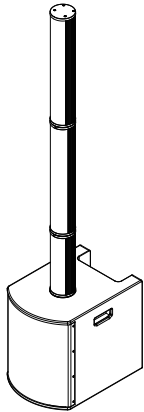

Quick Start

When mounting a speaker onto any stand, always ensure that the stand is on a flat, level surface, with the legs fully extended. Be sure to check that the maximum load weight for the stands is greater than the weight of the ARRAY SYSTEMS loudspeaker. Never use a stand with a maximum load weight lower than the speaker. Do not attempt to mount more than one speaker on a stand at one time.

The ARRAY SYSTEMS loudspeakers are heavy. It is recommended that a second person to help place the cabinet on a stand.

When the speaker is placed on a stand, always check the integrity and center of gravity of the system. If the speaker can be tipped easily, or the pole is swaying, it is recommended that you lower the height of the stand. Position the stand and route cables so that the performers and the audience cannot tip over or trip on the system.

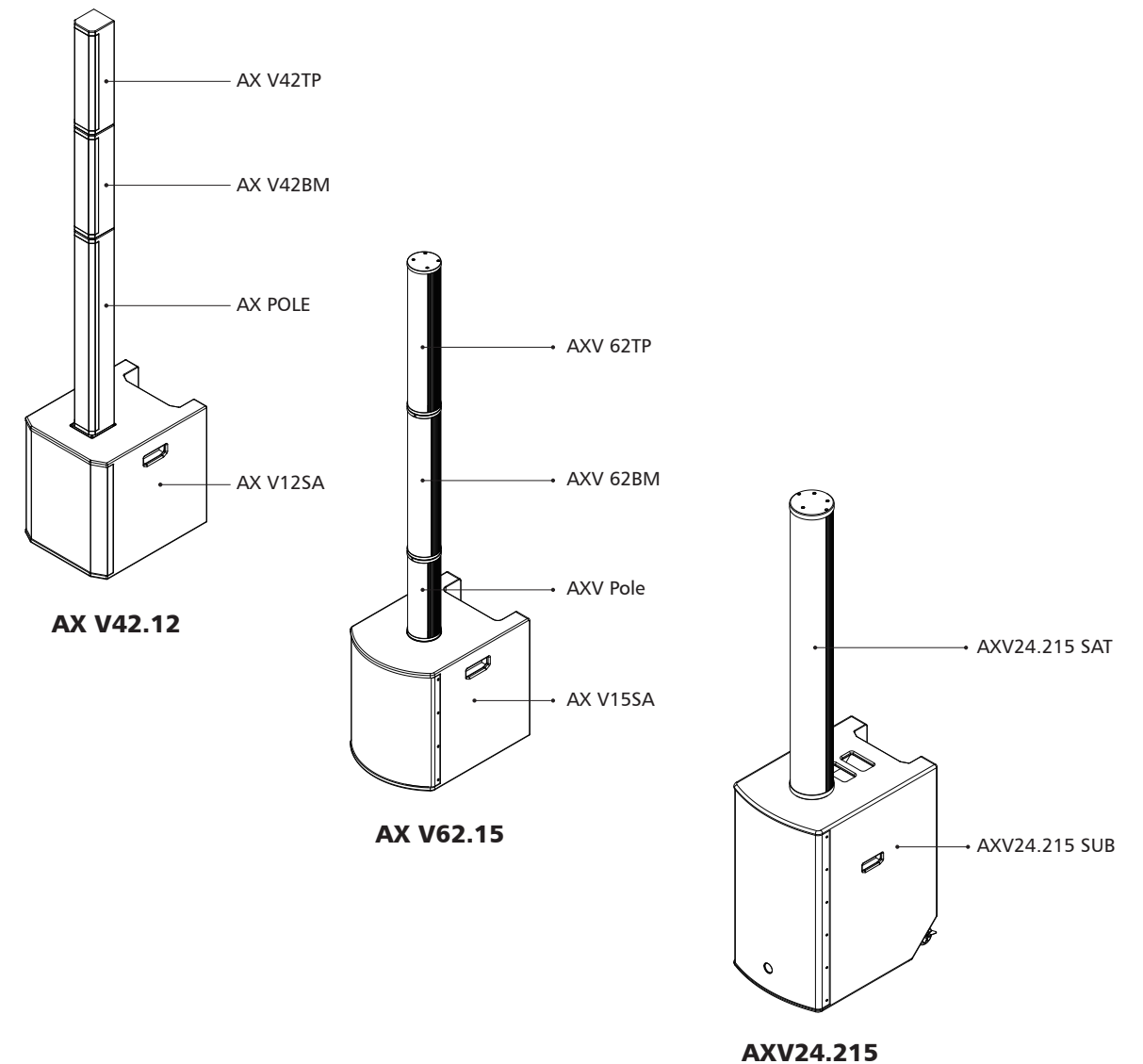

Connect Manner

AX V42.12

1. Insert the 4 PCS of fixed legs of **AX POLE** into the fixed seat of SUB, It means the assembly and connection of signal cable completed, details as below picture#1.
2. Snap the slot-terminal holder of **AX V42BM** into the upper protruding holder of **AX POLE**, and then push **AX V42BM** into slots along the opposite direction of grill. It means the assembly and connection of signal cable completed. details as below picture #2.
3. Snap the slot-terminal holder of **AX V42TP** into the upper protruding holder of **AX V42BM**, and then push **AX V42BM** into slots along the opposite direction of grill. It means the assembly and connection of signal cable completed . details as below picture #3.
4. Once assembly completed, no extra signal cable needed, based on the needs, user can rotate **AX V42BM/AX V42TP** towards left or right within 90 degree limit.

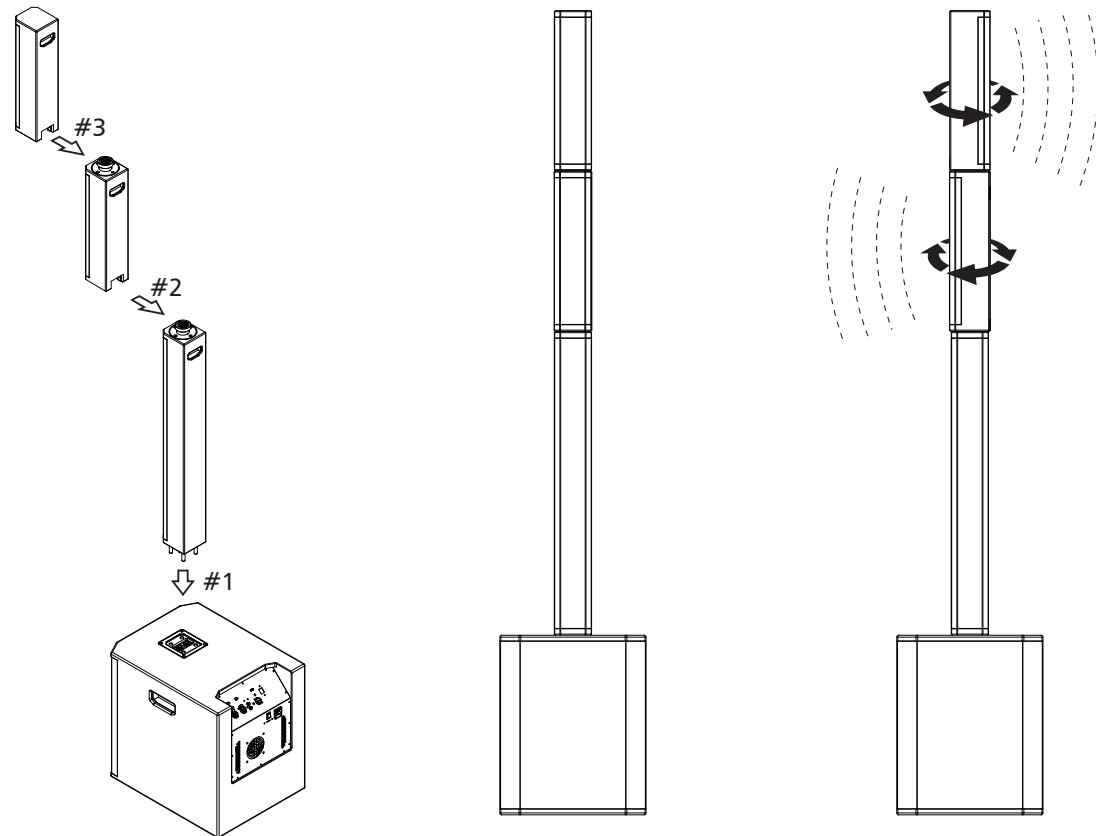

Technical Specifications

AXV42.12 SYSTEM: AXV12SA+AXV POLE+AXV42BM+AXV42TP

AXV42.12 System	
Frequency Response	42Hz – 20KHz (-10dB)
Total Amplifier Power	700 W Continuous / 1400W Program / 2800W Peak Class D @ 4 Ohms
Maximum SPL@1M	125dB
Crossover Frequency	250Hz
Dispersion(-6dB)	100°Horizontal
Dimensions(WxHxD)	385 x 1970 x 500mm (15.15" x 77.56" x 19.69")
Net Weight	31.06Kg (68.47 lbs)
AXV12SA	
System Type	12" Active Subwoofer Speaker Cabinet
Frequency Response(-6dB)	40 Hz – 250 Hz
Total Amplifier Power	700 W Continuous / 1400W Program / 2800W Peak Class D @ 4 Ohms
Amplifier, Subwoofer	350 W Continuous / 700W Program / 1400W Peak Class D @ 4 Ohms
Amplifier, Satellite	350 W Continuous / 700W Program / 1400W Peak Class D @ 4 Ohms
DSP Presets Modes	Center / Open / User
Electronic Protections	Over heat Protection/Short Circuit Protection/Digital Compressor
Cooling	Temperature-controlled fan
Connections	Input: 2 Combo-XLR&1/4", RCA In L&R, 1 XLR Thru&Mixout
External Controls	Volume Control/Switch for Input sens/Swtich for mode selector/Power ON with Green LED/Limiter with Red LED/Ground Lift/IP Control/MP3 and BT
Power Supply	115V/230V ~50/60Hz Switchable
Enclosure Construction	Plywood Cabinet,Resistant Black Paint, Metal Grille with Foam, Rubber Feet, Integrated side handles
Mounting	Holder with Input Jacks for Pole
Dimensions(WxHxD)	385 x 473 x 500mm (15.15" x 18.62" x 19.69")
Net Weight	21.5Kg (47.40 lbs)
AXV Pole	
Enclosure Construction	Plywood Cabinet, Resistant Paint, Metal Grille with Foam
Connector	2 x Electronic Adapter - 1 x Input Connector for Sub & Another with Input Connector for Satellite
Dimensions(WxHxD)	98 x 700 x 106.6mm(3.86" x 27.56" x 4.20")
Net Weight	2.70Kg (5.95 lbs)
AXV42BM	
System Type	3.5" Passive Speaker System
Output Power	120W Continuous, 240W Program, 480W Peak
Sensitivity (1W/1M)	95dB
Frequency Response(-6dB)	160Hz-20kHz
Impedance	8 ohms
Transducer Low	4 x 3.5" Ferrite Woofer, 1.0" (25.4mm) Voice Coil
Rotation	180 degree Mechanical Adjustment
Enclosure Construction	Plywood Cabinet, Resistant Paint, Metal Grille with Foam
Connector	2 x Electronic Adapter - 1 x Input Connector for AXV Pole & Another with Input Connector for AXV42TP
Dimensions(WxHxD)	98 x 448 x 106.6mm(3.86" x 17.64" x 4.20")
Net Weight	3.48Kg (7.67 lbs)
AXV42TP	
System Type	3.5" Passive Speaker System
Output Power	120W Continuous, 240W Program, 480W Peak
Sensitivity (1W/1M)	95dB
Frequency Response(-6dB)	160Hz-20kHz
Impedance	8 ohms
Transducer Low	4 x 3.5" Ferrite Woofer , 1.0" (25.4mm) Voice Coil
Rotation	180 degree Mechanical Adjustment
Enclosure Construction	Plywood Cabinet, Resistant Paint, Metal Grille with Foam
Connector	1 x Electronic Adapter - 1 x Input Connector for AX V42BM or AX Pole
Dimensions(WxHxD)	98 x 422 x 106.6mm(3.86" x 16.61" x 4.20")
Net Weight	3.41Kg (7.52 lbs)

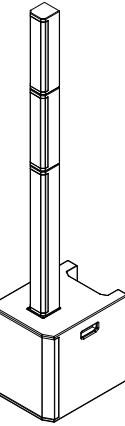

Wire Connections

-For Active Speaker Cabinets

As to these circumstances, audio connections is mostly intended for the signal flow, so, determine the wire configuration according to your real application system and its connecting facility. Normally, you have the following choices:

• Balanced

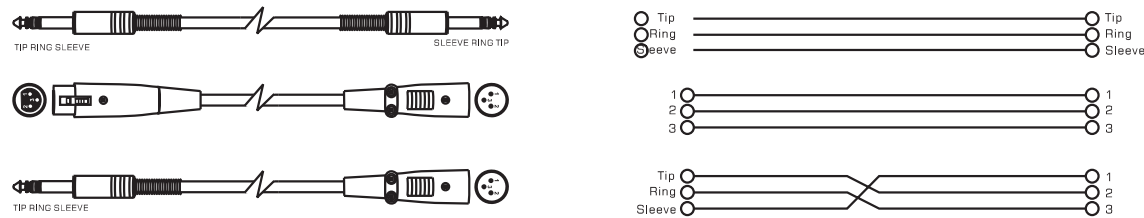

• Unbalanced

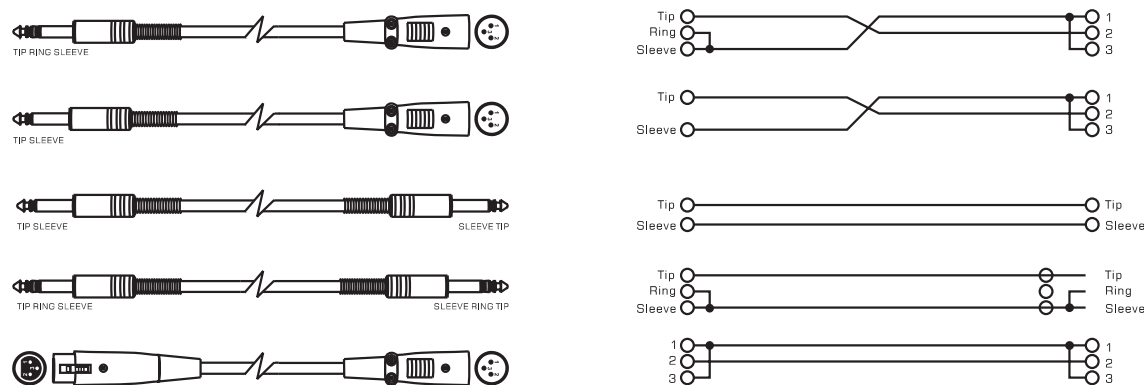

-For Passive Speaker Cabinets

Please only use the power connectors to make connections with other signal source equipment for the passive speaker cabinets. The power connector has four terminals: 1+, 1-, 2+, 2-.

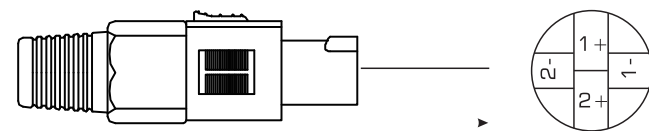

In our cabinets, only 1+/1- are used to connect the Speaker+/Speaker-, and 2+/2- are not used.

Connect Manner

AX V62.15

1. Place the SUB on a flat surface.
2. Push the POLE from front to back into the SUB connector until it is tight. -#1
3. Push the SAT -BM from front to back into the POLE connector until it is tight. -#2
4. Push the SAT -TP from front to back into the SAT -BM connector until it is tight. -#3
5. After the installation is completed, if you need to disassemble, press the "LOCK" button of the SUB connector and push the SAT forward slowly.

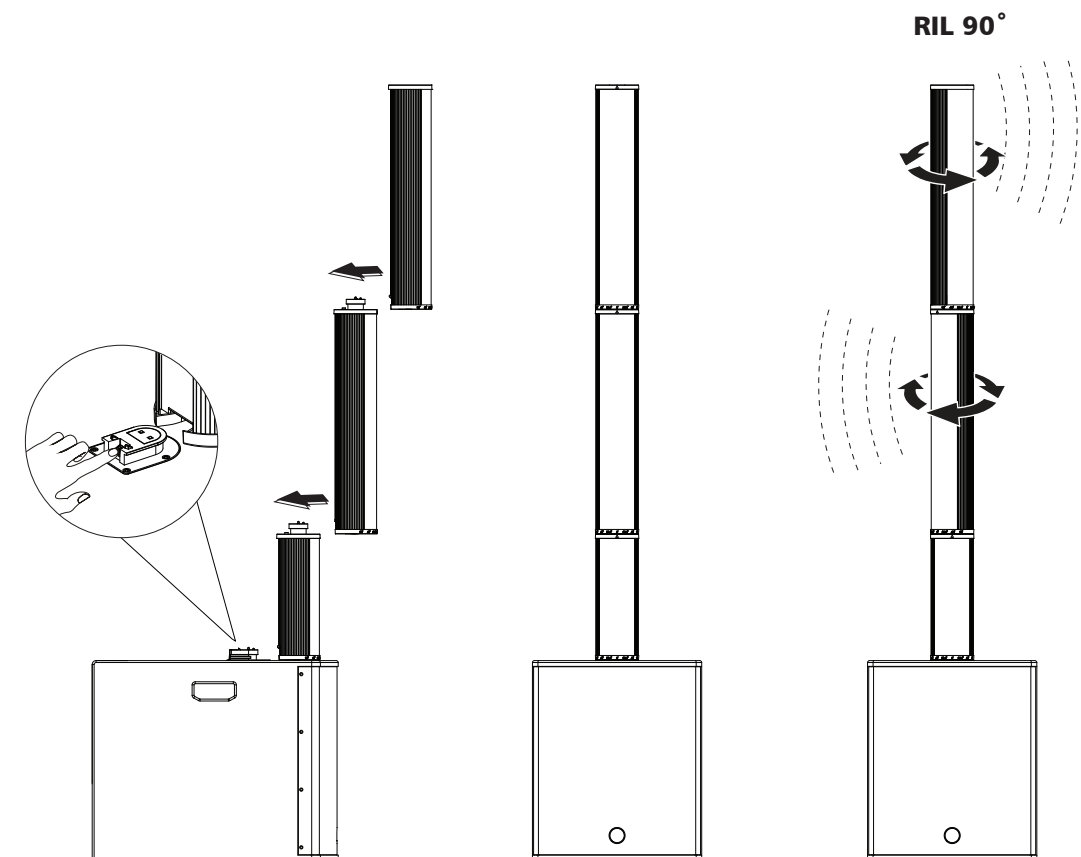

Connect Manner

AXV24.215

1. Place the AXV24.215 SUB on a flat surface.
2. Push the AXV24.215 SAT from front to back into the SUB connector until it is tight.
3. After the installation is completed, if you need to disassemble, press the "LOCK" button of the SUB connector and push the SAT forward slowly.

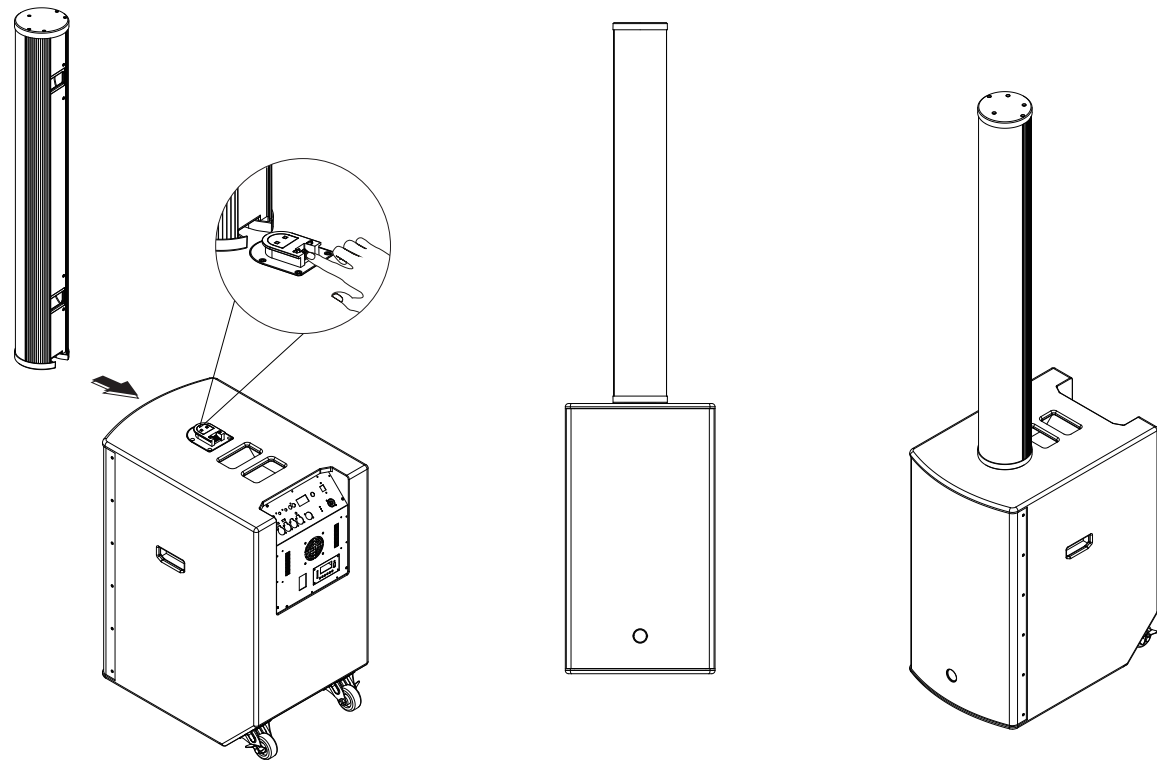

Connection Plate System

Make your initial connections with all the equipment powered off, and ensure that all the main volume controls are turned completely down.

Two Active Subwoofers & Two Passive Satellite Speakers

- 1) Connect one side of the signal cable to the output of your mixer (left / right) with a TRS or XLR connector and the other side of the cable to the line input (combo) in the active subwoofer (with a TRS to XLR connector). Then connect the speakon cable from the output of power in the Subwoofer to the satellites input.
- 2) Complete other connections as illustrated.
- 3) Turn on your mixer first, then the stereo power amplifier.
- 4) Turn up the volume controls of your amplifier to about 70%.
- 5) Use PFL function to get the proper input level for the mixer, and adjust the Main Mix Level control to manipulate the output level.
- 6) After using, turn off your stereo power amplifier first, then the mixer.

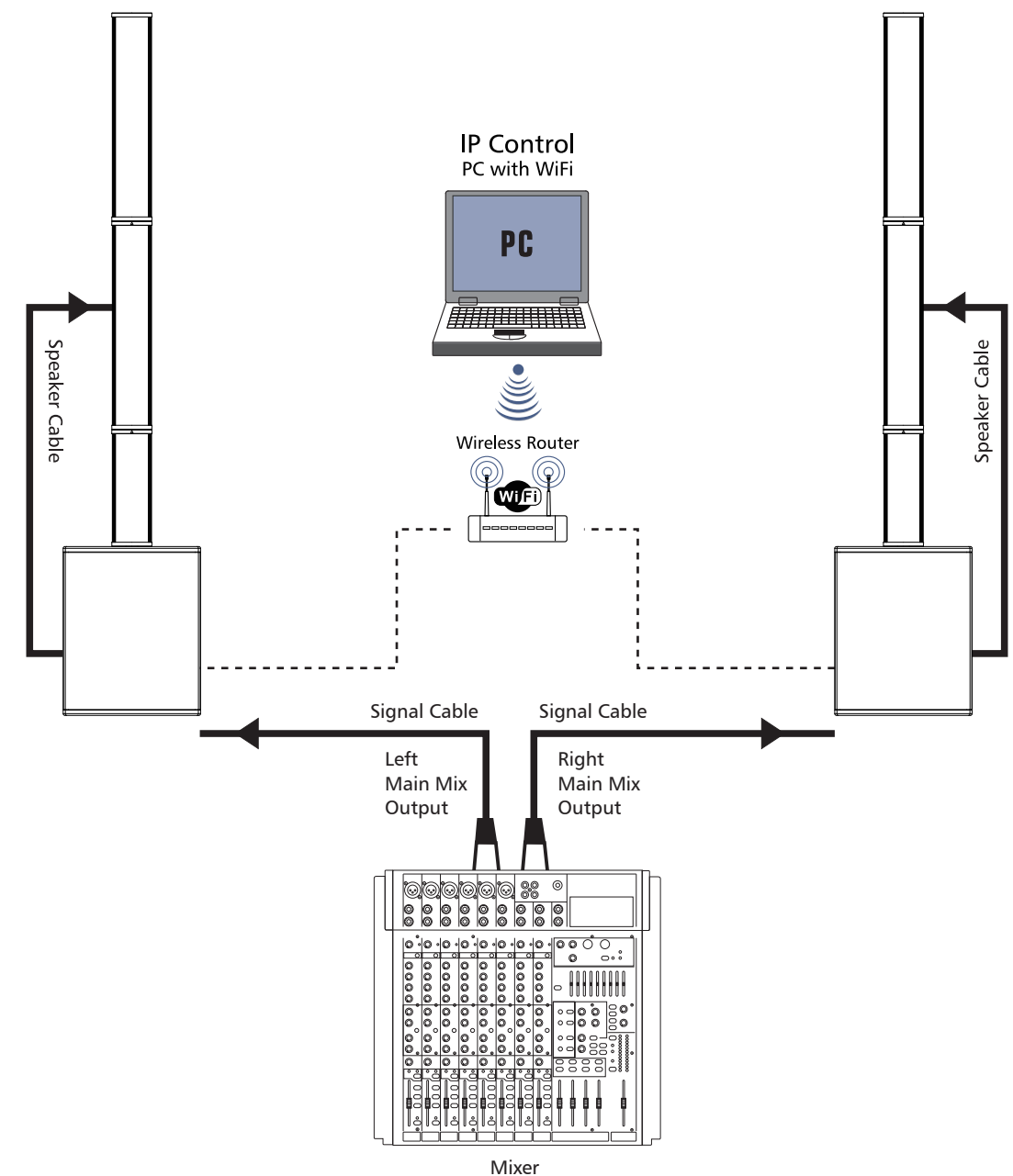

Connection Plate System

Make your initial connections with all the equipment powered off, and ensure that all the main volume controls are turned completely down.

- 1) Connect one side of the signal cable at your audio mixer into output left / right (with Stereo-Jack or XLR) and the other side of the cable into the line input (Stereo-Jack) of your active speaker cabinet.
- 2) Connect the power cord to mains.
- 3) Turn on your mixer first, then the active speaker cabinets.
- 4) Turn up the volume control of the active speaker cabinets.
- 5) Use PFL function to get the proper input level for the mixer, and adjust the Main Mix Level control to manipulate the output level.
- 6) After using, turn off your stereo power amplifier first, then the mixer.

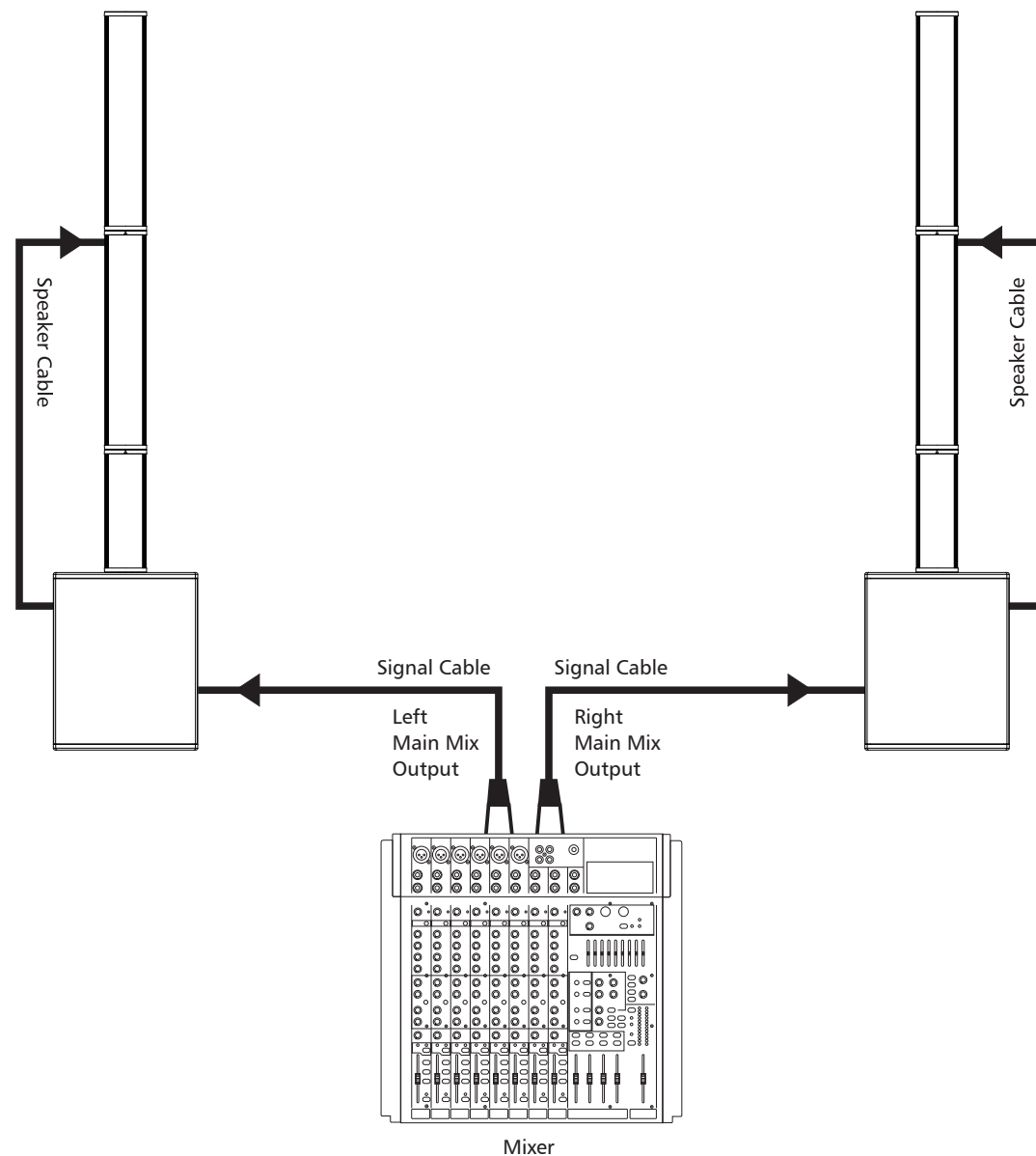

Back Panel Description

AX V 42.12

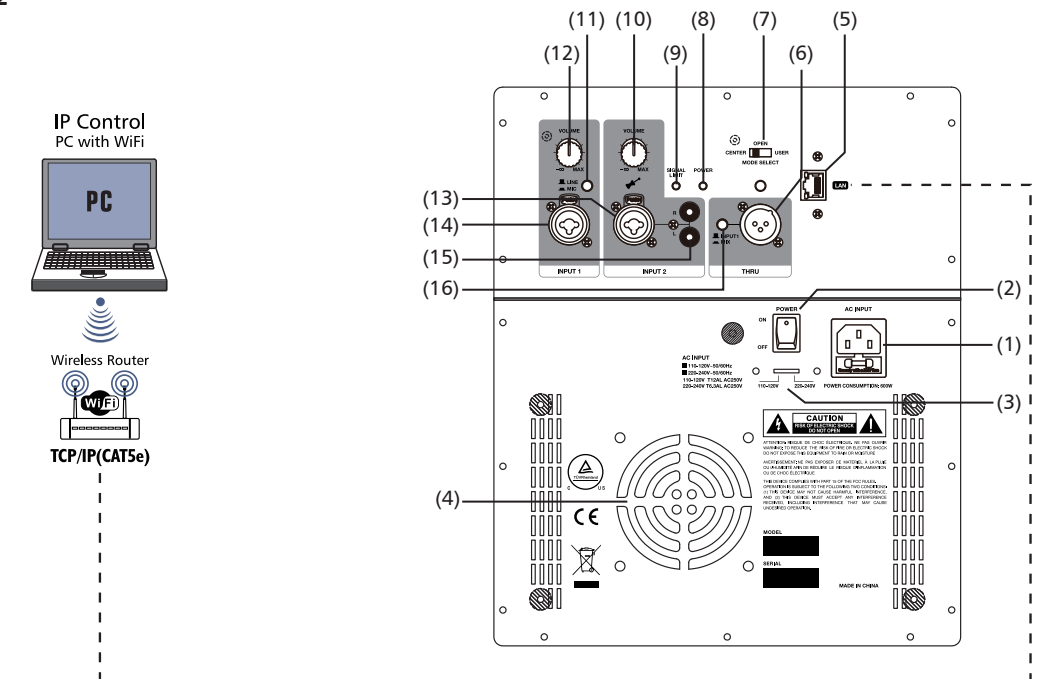

1. AC POWER SOCKET WITH MAIN FUSE.
2. ON-OFF MAIN POWER SWITCH.
3. MAIN FUSE
4. CONVECTION FAN
5. IP CONTROL
6. THRU OUTPUT ON XLR CONNECTOR
This is a male XLR-type connector that produces exactly the same signal that is connected to the main input jack or a mix of input1 and input2.
7. CENTER / OPEN / USER
CENTER: Allow use this subwoofer with the 2 satellite (AX V42TP and AX V42BM). Defaults factory preset for Both satellites never rotate and keep grill towards front
OPEAN: Allow use this subwoofer with the 2 satellite (AX V42TP and AX V42BM). Defaults factory preset for the AX V42TP (or AX V42BM) turn 45 degree towards left, another turn 45 degree towards right.
8. POWER. GREEN LED, INDICATE ON STATUS.
9. SIGNAL / LIMIT, RED LED, INDICATE ON STATUS.
10. INPUT2 ON COMBO CONNECTOR.
11. LINE / MIC SWITCH (CHANNEL INPUT1 ONLY)
12. LINE / MIC INPUT1 ON COMBO CONNECTOR.
13. XLR AND 1/4" COMBO INPUT2
INPUT2 may accept Hi-Z sources (such as guitars) via the TRS 1/4" input, or line-level signal via XLR.
NEVER connect the output of an amplifier directly to the input of the loudspeaker. This could damage the input circuitry of the active loudspeaker.
14. XLR AND 1/4" COMBO INPUT1
INPUT1 may accept a MIC or line-level signal via XLR or line-level signal via TRS 1/4" cable.
Be aware of the position of the MIC / line switch (12).
15. RCA INPUTS (INPUT2 ONLY).
16. INPUT1 / MIX SWITCH (THRU OUTPUT)
This switch allows you to choose whether only the input1 signal is sent out to the next loudspeaker (switch out-input1) or mix of the input1 and input2 signals are sent out to the next loudspeaker (switch in-Mix).

Back Panel Description

AX V62.15

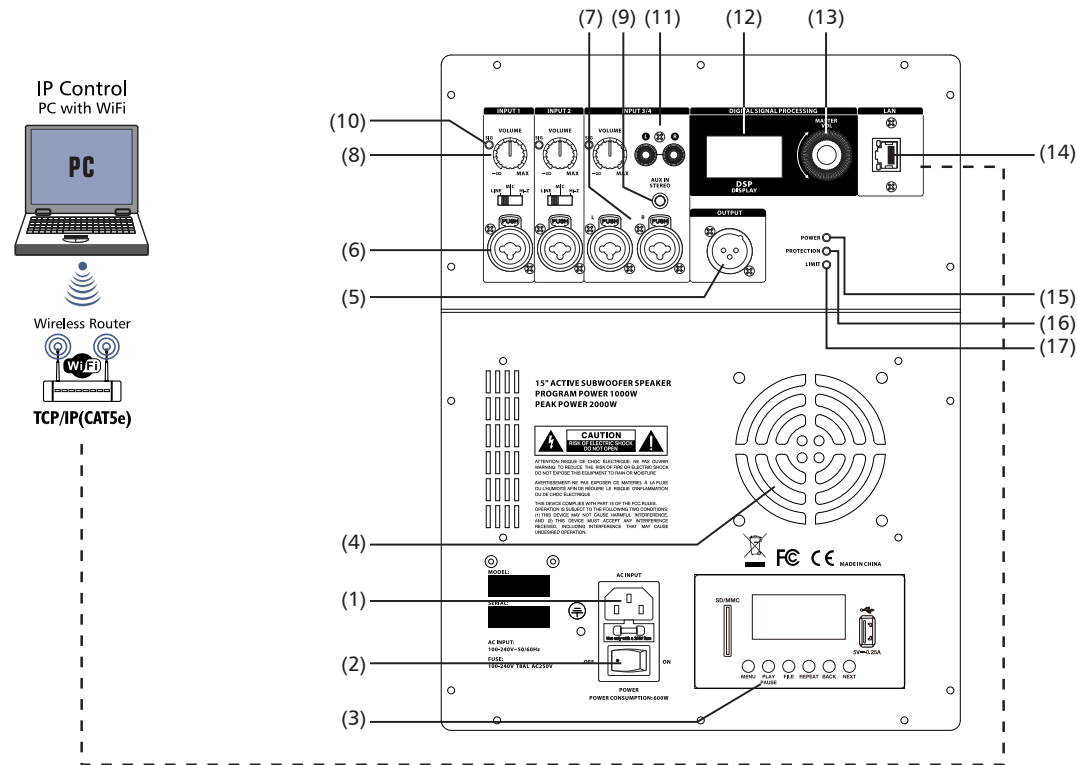

1. AC INPUT-The AC connection is established via the IEC connector. The IEC connector is compatible with a lockout power cord (not included).
2. POWER - AC switch for turning the power on or off. When POWER is turned on, the power led lights up and LCD screen lights up.
3. MP3/BT PLAYER for option.
4. Convection fan.
5. OUTPUT - The XLR output sends mixed input signals to other speakers or subwoofers, Input level controls the level of signal sent to the OUTPUT, The MASTER VOL or DSP control settings do not affect the OUTPUT.
6. INPUT1 / INPUT2 - FOR line\ MIC or HI-Z input level control is available for INPUT 1/2
7. INPUT3/4 - FOR line stereo input level control is available for INPUT 3/4
8. RCA INPUTS- FOR line stereo input level control is available for INPUT 3/4
9. VOLUME- Input level is used to adjust the level control of the level of a signal input.
10. AUX IN - Line input level control is available for stereo
11. SIG / LIMITER signal light, it will light green when there is signal, and the red light will start to light when the amplifier starts to compress.
12. LCD - DSP Control and monitoring interface
13. MASTER VOL - Total volume adjustment ,range: -60dB ~ +10dB. DSP-Scroll through the menus and select the available options. Press the MASTER VOL knob to enter the DSP menu item.
14. IP CONTROL
15. POWER indicators - the POWER LED will light up when turned on.
16. PROTECTION indicators - the PROTECTION LED will light up when an exception occurred in DSP
17. LIMITER indicators - the LIMITER LED will light up when the amplifier starts to compress

Back Panel Description

AXV24.215

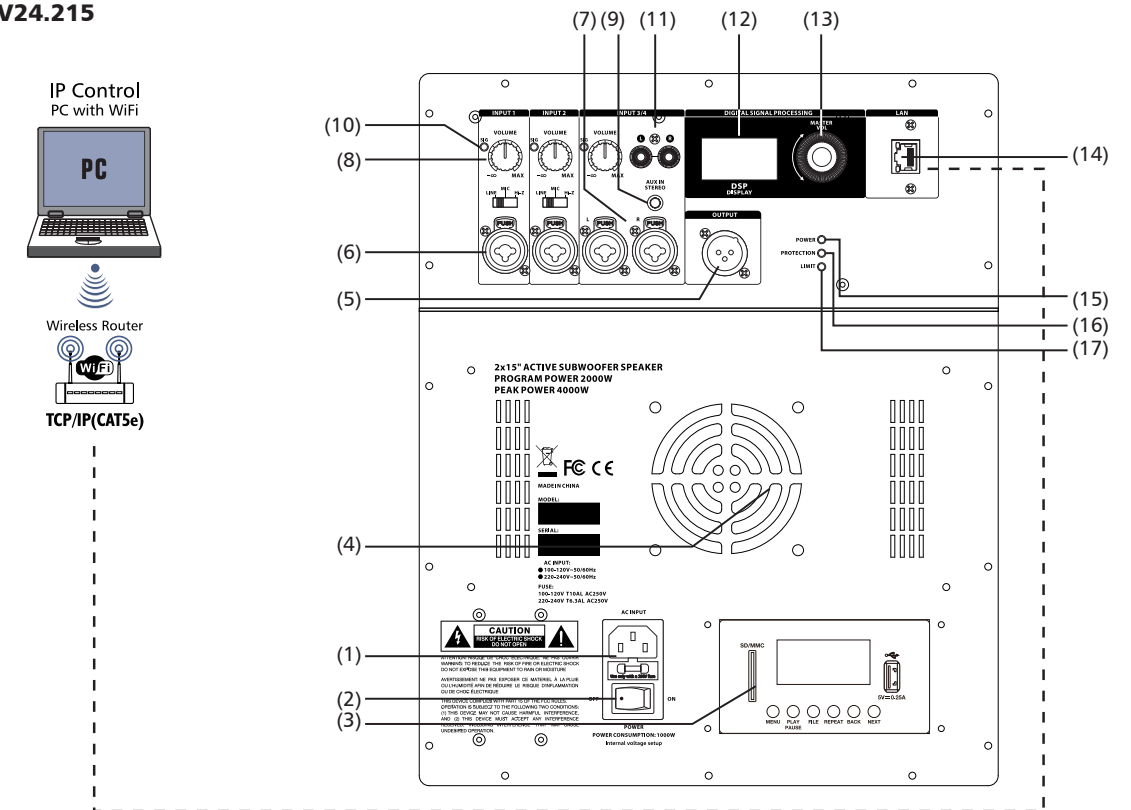

1. AC INPUT-The AC connection is established via the IEC connector. The IEC connector is compatible with a lockout power cord (not included).
2. POWER - AC switch for turning the power on or off. When POWER is turned on, the power led lights up and LCD screen lights up.
3. MP3/BT PLAYER for option.
4. Convection fan.
5. OUTPUT - The XLR output sends mixed input signals to other speakers or subwoofers, Input level controls the level of signal sent to the OUTPUT, The MASTER VOL or DSP control settings do not affect the OUTPUT.
6. INPUT1 / INPUT2 - FOR line\ MIC or HI-Z input level control is available for INPUT 1/2
7. INPUT3/4 - FOR line stereo input level control is available for INPUT 3/4
8. RCA INPUTS- FOR line stereo input level control is available for INPUT 3/4
9. VOLUME- Input level is used to adjust the level control of the level of a signal input.
10. AUX IN - Line input level control is available for stereo
11. SIG / LIMITER signal light, it will light green when there is signal, and the red light will start to light when the amplifier starts to compress.
12. LCD - DSP Control and monitoring interface
13. MASTER VOL - Total volume adjustment ,range: -60dB ~ +10dB. DSP-Scroll through the menus and select the available options. Press the MASTER VOL knob to enter the DSP menu item.
14. IP CONTROL
15. POWER indicators - the POWER LED will light up when turned on.
16. PROTECTION indicators - the PROTECTION LED will light up when an exception occurred in DSP
17. LIMITER indicators - the LIMITER LED will light up when the amplifier starts to compress

SEIKAKU TECHNICAL GROUP LIMITED

客	戶						
料	號	NF05447					
品	名	說明書-英文					
規	格	AXV SYSTEM_V1.2					
公司機種(客戶機種)成品料號		AXV 62.15					
重 量 / 基 數		0.015kg/1					
材 質		NH00149 1:1					
紙張展開性質		<input checked="" type="checkbox"/> A3	<input type="checkbox"/> A4	<input type="checkbox"/> A5	<input type="checkbox"/> 其它	紙張展開數量	5pcs
核 准		審 核		校 稿		製 稿	<div style="border: 1px solid black; border-radius: 50%; padding: 5px; text-align: center;"> 研發部 2020.03.27 馮斌 </div>
產品文件編號:							
陽片數量: 10 張							
修改紀錄		版本	更改者	日期			
修改機圖		1.2	馮斌	2020.03.27			
變更單號: QHFBE004-20200300015							