

# MOBILE MIXER AMPLIFIER BROADCAST SYSTEM

## WU-100 SERIES

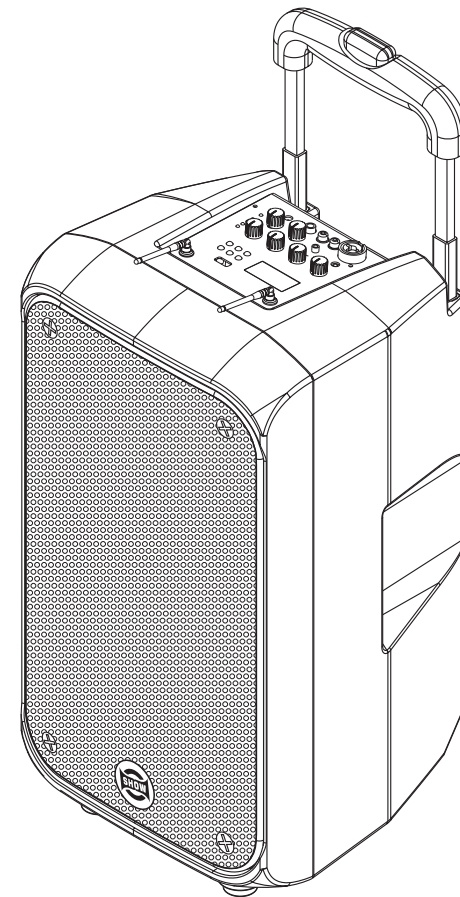

### SEIKAKU TECHNICAL GROUP LIMITED

No. 1, Lane 17, Sec. 2, Han Shi West Road, Taichung 40151, Taiwan

<http://www.altoproaudio.com> Tel: 886-4-22313737

email: [alto@altoproaudio.com](mailto:alto@altoproaudio.com) Fax: 886-4-22346757

All rights reserved to ALTO. All features and content might be changed without prior notice. Any photocopy, translation, or reproduction of part of this manual without written permission is forbidden. Copyright © 2005 SEIKAKU GROUP

NF04888-1.0

[Wwww.show-pa.com](http://www.show-pa.com)

**IMPORTANT!**

**Please read this manual carefully before operating  
this unit for the first time.**

All rights reserved to SHOW. All features and content might be changed without prior notice. Any photocopy, translation, or reproduction of part of this manual without written permission is forbidden.

9. ACCESSORIES

|                     |        |
|---------------------|--------|
| Power Cord          | × 1    |
| Wireless Microphone | × 1× 2 |
| User Manual         | × 1    |
| Battery             | × 1    |
| Warranty Card       | × 1    |

10. CAUTION

- 1. Do not use any volatile solvents such as toluene, Alcohol or gasoline for safety, keep product clean and free from dust.
- 2. In summer, Do not put this equipment in the sun directly.
- 3. Do not place the unit in the rain directly when used in the outdoor.
- 4. After using, press the power switch to turn off the power.
- 5. If the equipment is not used for a long time, please recharge the battery to at least 80% of its full level to lengthen the battery life.

TABLE OF CONTENTS

1. IMPORTANT SAFETY INFORMATION ..... 1

2. FEATURE ..... 2

3. DESCRIPTION OF VARIOUS PARTS ..... 3

4. RECEIVER DISPLAY ..... 6

5. METAL HAND MIC ..... 7

6. BELTPACK MIC ..... 8

7. TECHNICAL SPECIFICATION ..... 12

8. CONNECTION DIAGRAM ..... 13

9. ACCESSORIES ..... 15

10. CAUTION ..... 15

## SAFETY RELATED SYMBOLS



This symbol, wherever used, alerts you to the presence of un-insulated and dangerous voltages within the product enclosure. These are voltages that may be sufficient to constitute the risk of electric shock or death.



This symbol, wherever used, alerts you to important operating and maintenance instructions. Please read.



Protective Ground Terminal



AC mains (Alternating Current)



Hazardous Live Terminal

**ON:** Denotes the product is turned on.

**OFF:** Denotes the product is turned off.

### WARNING

Describes precautions that should be observed to prevent the possibility of death or injury to the user.



Disposing of this product should not be placed in municipal waste and should be separate collection.

### CAUTION

Describes precautions that should be observed to prevent damage to the product.

### WARNING

#### • Power Supply

Ensure that the mains source voltage (AC outlet) matches the voltage rating of the product. Failure to do so could result in damage to the product and possibly the user.

Unplug the product before electrical storms occur and when unused for long periods of time to reduce the risk of electric shock or fire.

#### • External Connection

Always use proper ready-made insulated mains cabling (power cord). Failure to do so could result in shock/death or fire. If in doubt, seek advice from a registered electrician.

#### • Do Not Remove Any Covers

Within the product are areas where high voltages may present. To reduce the risk of electric shock do not remove any covers unless the AC mains power cord is removed.

**Covers should be removed by qualified service personnel only.**

No user serviceable parts inside.

#### • Fuse

To prevent fire and damage to the product, use only the recommended fuse type as indicated in this manual. Do not short-circuit the fuse holder. Before replacing the fuse, make sure that the product is OFF and disconnected from the AC outlet.

#### • Protective Ground

Before turning the product ON, make sure that it is connected to Ground. This is to prevent the risk of electric shock.

Never cut internal or external Ground wires. Likewise, never remove Ground wiring from the Protective Ground Terminal.

#### • Operating Conditions

Always install in accordance with the manufacturer's instructions.

To avoid the risk of electric shock and damage, do not subject this product to any liquid/rain or moisture. Do not use this product when in close proximity to water.

Do not install this product near any direct heat source.

Do not block areas of ventilation. Failure to do so could result in fire.

Keep product away from naked flames.

## IMPORTANT SAFETY INSTRUCTIONS

Read these instructions

Follow all instructions

Keep these instructions. Do not discard.

Heed all warnings.

Only use attachments/accessories specified by the manufacturer.

#### • Power Cord and Plug

Do not tamper with the power cord or plug. These are designed for your safety.

Do not remove Ground connections!

If the plug does not fit your AC outlet seek advice from a qualified electrician.

Protect the power cord and plug from any physical stress to avoid risk of electric shock.

Do not place heavy objects on the power cord. This could cause electric shock or fire.

#### • Cleaning

When required, either blow off dust from the product or use a dry cloth.

Do not use any solvents such as Benzol or Alcohol.

For safety, keep product clean and free from dust.

#### • Servicing

Refer all servicing to qualified service personnel only. Do not perform any servicing other than those instructions contained within the User's Manual.

## WU-100 BLOCK DIAGRAM

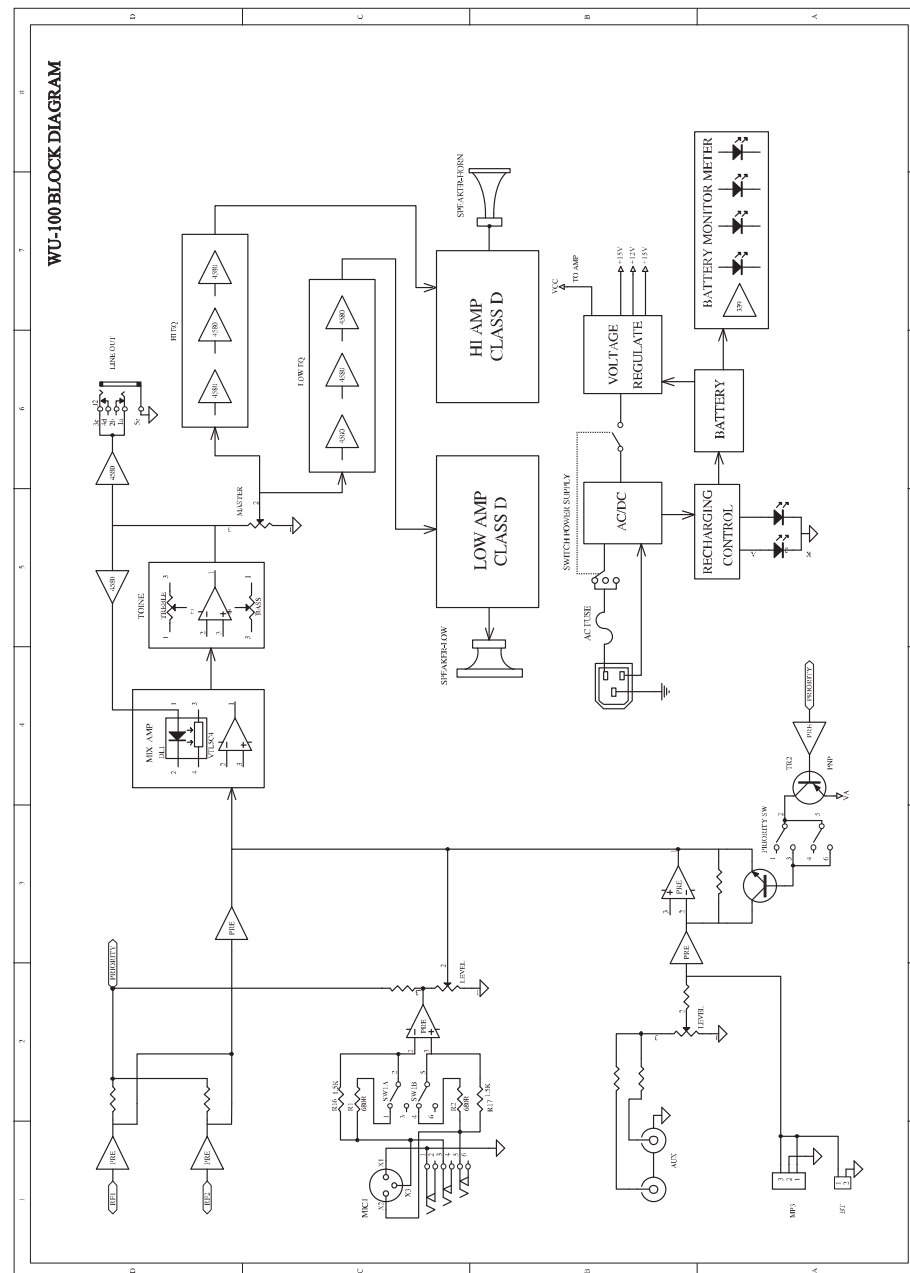

## 8. CONNECTION DIAGRAM

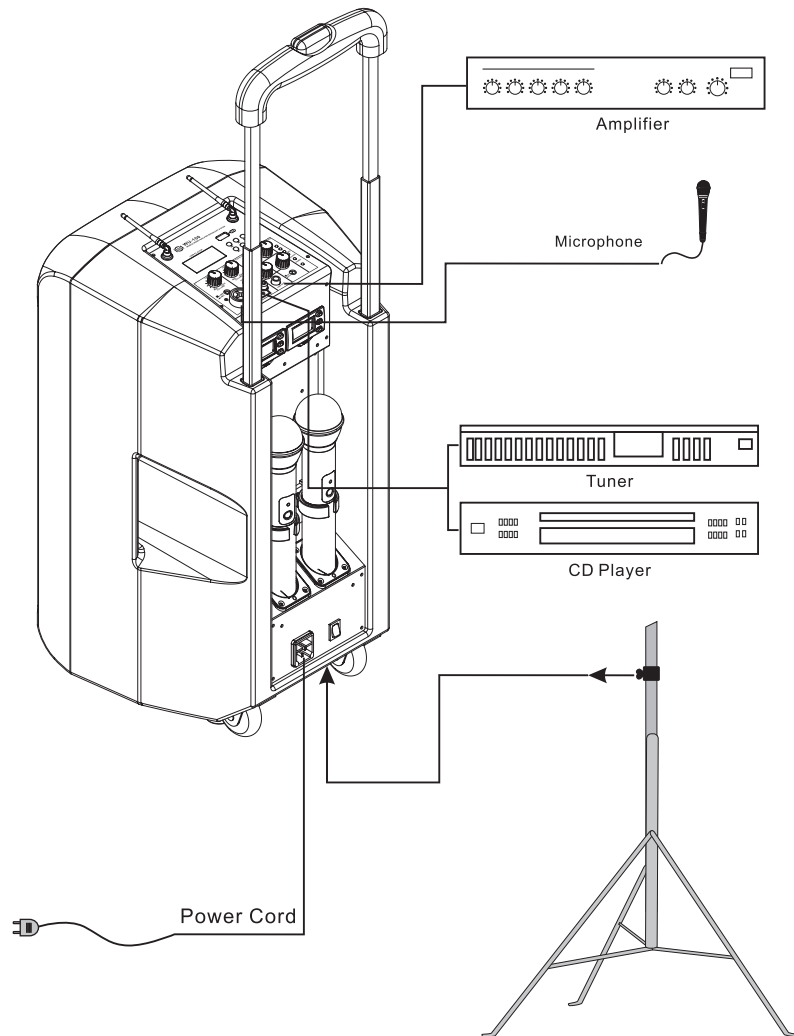

## 2. FEATURE

- User- friendly operation.
- It is equipped with professional wireless receiving module with quartz locked, output volume control when the wireless module works, MP3 player and AUX output can be muted.
- Build-in one microphones and a pair of AUX input with individual volume control.
- Build-in two AUX inputs and one line output.
- Build-in two tone controls (treble,bass) and a master volume controls.
- Digital MP3 player with clear sound, easy operation.
- Class D power amplifier and professional two way crossover.
- Professional mounting hole for heightening this unit to meet the requirements.
- Wheel and handle for easy carriage.
- Two power supplies: AC 115-120V/220-240V, DC22.2V ( **LITHIUM BATTERY**)
- When AC works, Power LED lights up; when battery works, Power LED and battery level LED light up.
- When AC inputs, the battery will charge automatically, and Recharge indicator will light red. After full recharged, the indicator will light green.
- When battery is available, it will indicate low voltage and red LED of battery will light up.

3. DESCRIPTION OF VARIOUS PARTS

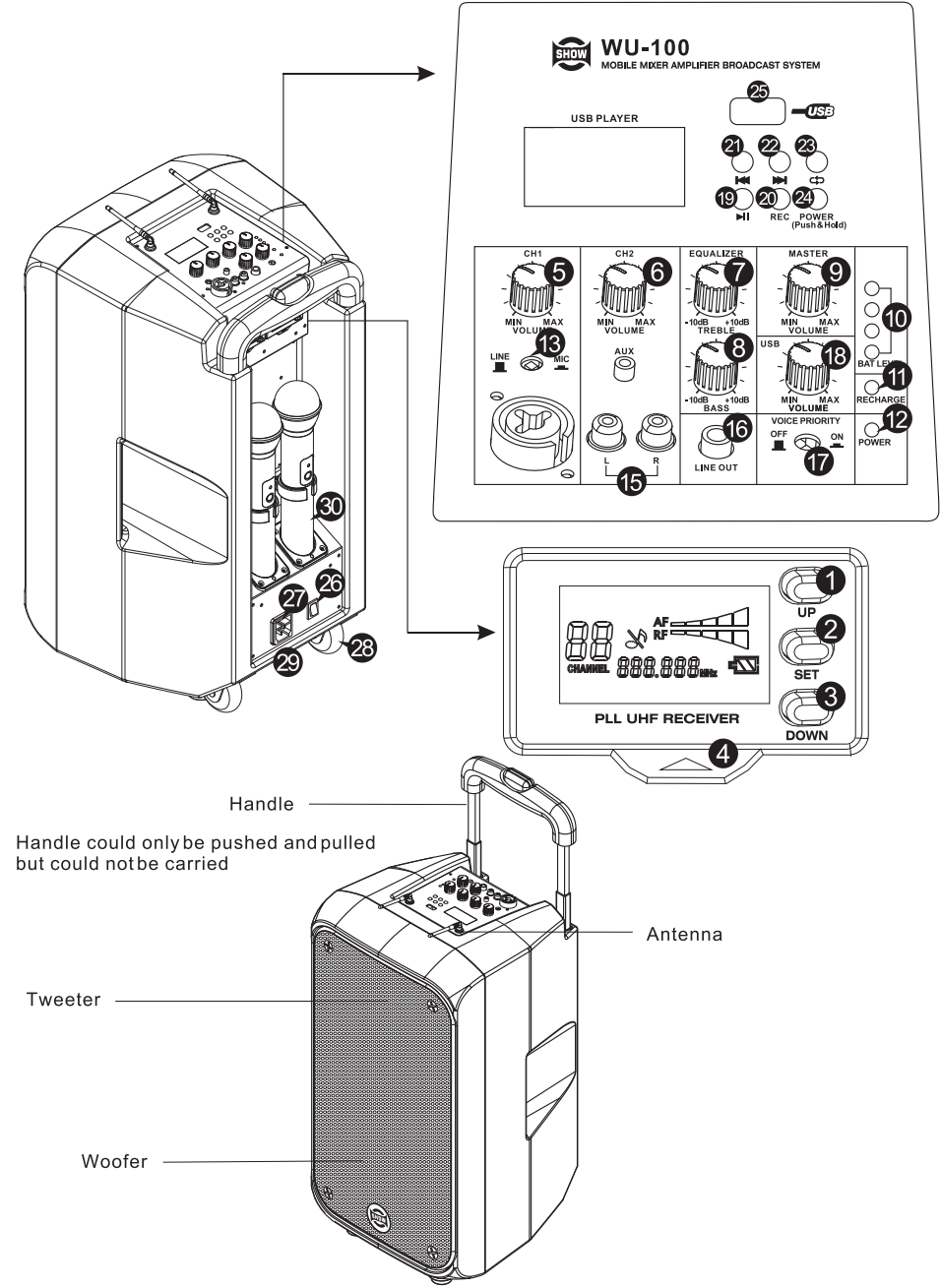

7. TECHNICAL SPECIFICATION

| Items                    | Model | WU-100   |
|--------------------------|-------|--|
| Power Supply             |       | AC:100V-120V/220-240V/ Battery:25.9V(lithium battery)  |
| System Type              |       | 2-Way Active Vented Speaker  |
| Transducer Low           |       | 10" Woofer, 1.5"Voice coil   |
| Transducer driver        |       | 1"Ferrite Driver, 1"Voice coil   |
| Horn Coverage H°xV°      |       | 90° Hx45°V   |
| Frequency Response(-6dB) |       | 65Hz-20KHz   |
| Crossover Frequency      |       | 5KHz   |
| Max SPL                  |       | 117dB Max  |
| AMP Power Output         |       | RMS:200W(AC)(LF-Class D 135W&HF-Class D 65W)   |
| Input sensitivity        |       | CH1 MIC:-35dBu(±1dBu)<br>CH1 LINE:-3dBu(±1dBu)<br>CH2 AUX:-10dBu(±1dBu)  |
| Equalizer Controls       |       | BASS:±10 dB ( at 100Hz);<br>TREBLE:±10 dB ( at 10K );  |
| External Controls        |       | Master Volume Controls : MIC&LINE Switch : MIC1, AUX each Volume Controls: Voice Priority Switch: Power Indicators;Recharged Indicators; Battery Level Indicators; |
| Voice Priority           |       | MIC1 and Wireless  |
| Battery charge time      |       | Less than 4 hours  |
| Battery ues time         |       | More than 2 hours (Regular Play)   |
| Wireless Frequency band  |       | 200MHz or 800MHz or 2.4GHz   |
| Built-in player          |       | MP3 or Bluetooth   |
| Enclosure Construction   |       | Plastic cabinet, Trapezoidal ,Metal grille,Rubber foot,handle.   |
| Mounting                 |       | 36MM standard pole-mount   |
| Dimensions(HxWxD)        |       | 568(H)x300(W)x300(D)mm   |
| Net Weight               |       | 12.8(KG)   |
| Volume                   |       | 3.9CFT   |

Place the transmitter about 15~30cm from the front of the receiver with the transmitter's IR window facing the display on the front panel of the receiver.

Press and hold the receiver UP/DOWN button to set the transmitter to the same channel as the receiver via infrared transmission.

When the transmission is complete, the receiver will receive RF signal and tone key from the transmitter.

The RF indicator of the screen will light on the front panel of the receiver.

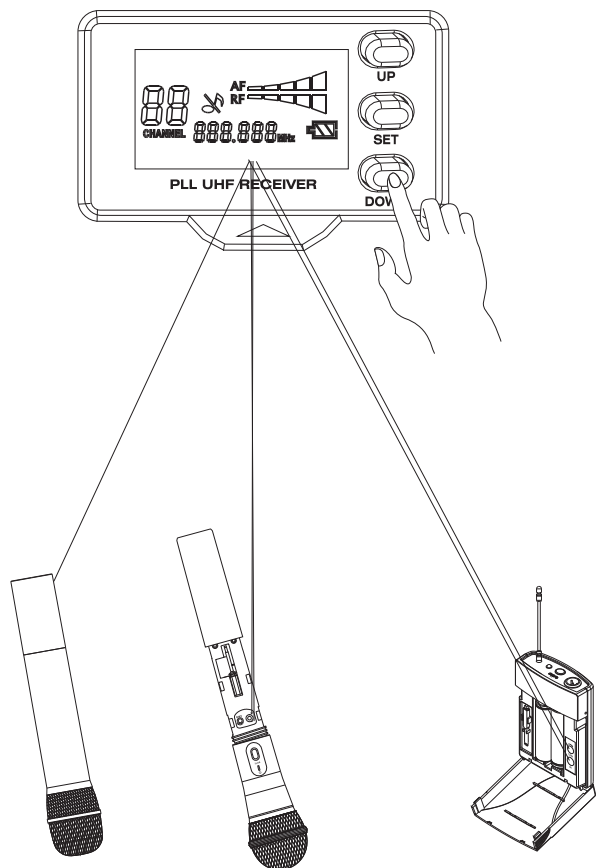

① **UP**

② **SET**

③ **DOWN**

④ **Button for popping out the module**

- Short press: Increase the receive frequency
- Long press for 3 seconds: automatically scan the unused frequency CH and enter the IR matching mode. The CH code flashes this time.
- Long press for 6 seconds: Rapidly increase the frequency, the CH code flashes and enter the IR matching mode after releasing the "SET" button.
- Short press for one time: Enter the volume controlling mode and the volume can be adjusted by "UP" and "DOWN".
- Short press for two times: Enter SQUELCH controlling mode, SQUELCH can be adjusted by "UP" and "DOWN".
- Short press: Reduce the receive frequency
- Long press for 3 seconds: automatically scan the unused frequency CH and enter the IR matching mode. The CH code flashes this time.
- Long press for 6 seconds: Rapidly increase the frequency, the CH code flashes and enter the IR matching mode after releasing the button.

⑤ **CH1 Volume Control**

This knob is used to control the CH1 level.

⑥ **CH2 Volume Control**

This knob is used to control the CH2 level.

⑦ **TREBLE VOLUME CONTROL**

This knob is used to control the treble level with range going from +10dB--10dB.

⑧ **BASS VOLUME CONTROL**

This knob is used to control the bass level with range going from +10dB--10dB.

⑨ **Master Volume Control**

This knob is used to control the Master level.

⑩ **Battery level LED**

Battery level indicator

⑪ **Recharge Indicator LED**

Charge indicator: lights red when charging and lights green after fully charged.

⑫ **Power LED**

The Power LED lights up when the amplifier is powered ON.

⑬ **CH1 LINE and MIC Switch**

MIC inputs when pressing MIC Switch, line inputs when the MIC Switch is popped out.

⑭ **LINE1 or MIC1 Input**

They are used for both balanced and unbalanced inputs.

⑮ **CH2 AUX Input**

It is used for AUX input.

⑯ **LINE OUT**

It is connected to recorder and pass on mixed signal.

⑰ **Voice priority**

When this button is engaged, CH1, RF1&RF2 will have priority over AUX and MP3. AUX and MP3 will be muted. When this button is disengaged, all the channels can work simultaneously against.

⑮ **USB Volume control**

This knob is used to control the USB player level.

⑯ **Play/Pause**

⑰ **Record**

Press this button once and you're ready to record, press is down and start recording. to stop press the POWER button.

⑱ **Previous song**

Play the next song.

⑳ **Next song**

Press this knob to control the volume down or up.

㉑ **Repeat**

Select between different repeat modes(repeat all, repeat one song, shuffle and normal playback.)

㉒ **POWER(on/off)**

Press and hold this button for both on and off.

㉓ **USB PORT**

For connecting with USB memory.

㉔ **POWER SWITCH**

If the switch is set to the position "ON", both AC and DC supply is connected, AC supply has priority over DC supply. When no AC voltage input, it will automatically switch to DC supply, the unit keeps working during AC/DC is switching. If the switch is set to the position "OFF", the whole unit stops working. If the switch is set to the position "RECHARGE", the built-in battery is recharging, but the unit is not working.

㉕ **AC inlet, voltage**

115-120V50-60Hz, 220-240V50-60Hz. Please check the voltage available in your country and how the voltage for your unit is configured before attempting to connect your unit to the main AC.

㉖ **Wheel**

㉗ **Rubber Feet**

㉘ **Charging indicator LED**

lights red when charging and lights green after fully charged.

With the transmitter powered off, install two fresh AA batteries into the MIC .

Leave the battery compartment open.

Turn on the power to the transmitter by pressing and holding Power switch; the indicator LED will light green.

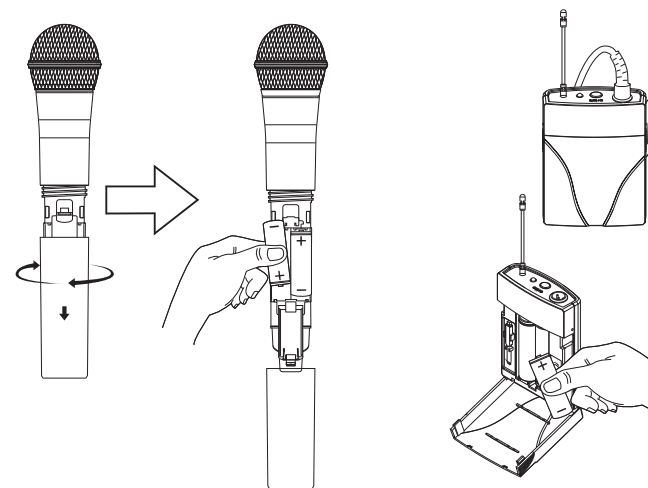

Press the UP/DOWN button on the front of the receiver to choose an available channel.

The channel number will increase by two digit, from 00-99. Once the last channel has been reached, the count will cycle back to 00.

Press and hold the UP button for 2 seconds to send the channel information to the transmitter via infrared transmission.

Press and hold DOWN button for 2 seconds and then start to scan full frequency and finally automatically choose clearest channel to send channel info to transmitter via infrared transmission.

Press and hold the UP button the display channel will be fast forward.

Press and hold the DOWN button the display channel will be fast backward.

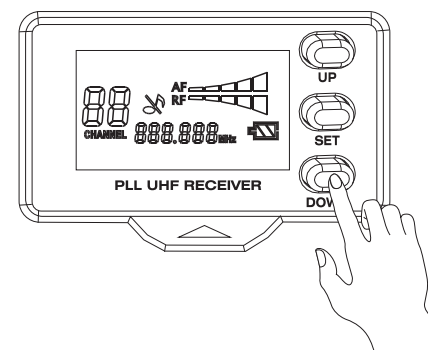



#### ④ MINI 4P CONNECTOR

- Ⓐ Pin 1, GND
- Ⓑ Pin 2, Phantom power supply for Condenser microphone
- Ⓒ Pin 3, designed for Guitar, bass and keyboards
- Ⓓ Pin 4, designed for Dynamic or condenser microphone

#### ⑤ IR Receiving Section

This window is used to capture the infrared signal sent from the receiver during the IR UP/DOWN to channelize the transmitter.

#### ⑥ Input GAIN Control

This control adjusts the transmitter input sensitivity to work with microphone and instruments inputs. For optimal performance, using the included screwdriver, set the input GAIN control to where you can see the RF display of receiver screen become full light, then turn down until the RF display not full light (less than five).

#### ⑦ Driver

Designed for adjusting the MIC input GAIN.

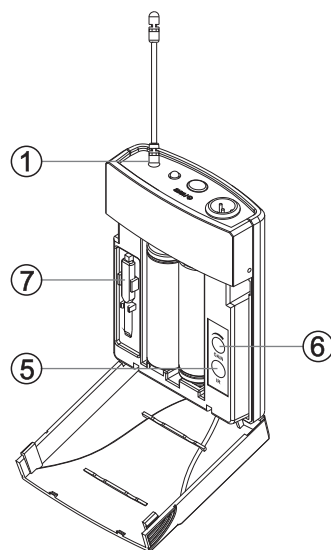
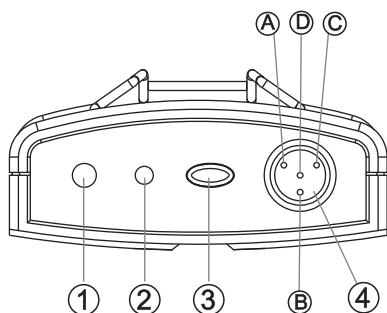

## 4. RECEIVER DISPLAY

### • Standby interface

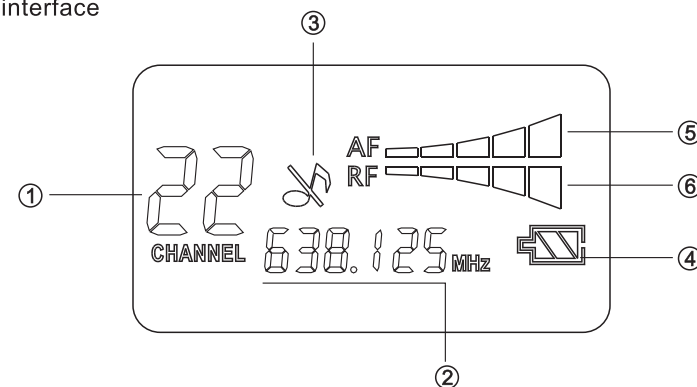

- ① Frequency code
- ② Frequency display
- ③ Mic Mute indicator
- ④ Power level of the battery
- ⑤ AF power indicator
- ⑥ RF power indicator

### • The interface of controlling the volume

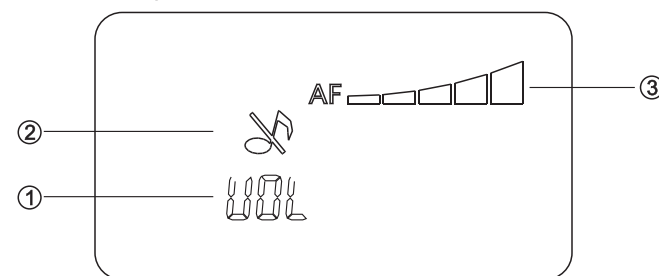

- ① Volume control
- ② Mute or unmute
- ③ AF level indicator

### • The interface of controlling the distance

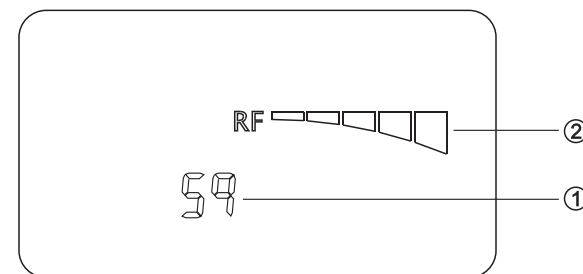

- ① SQUELCH control
- ② SQUELCH indicator

## PLASTIC HAND MIC

- ① **Grille Holder**
- ② **Tube**
- ③ **Tail tube**
- ④ **Status Indicator**

This LED displays the operation mode:

|              |                  |
|--------------|------------------|
| GREEN        | Normal Operation |
| RED          | Mute             |
| Flashing RED | Low power        |

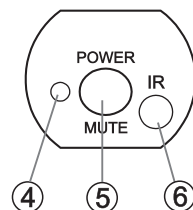
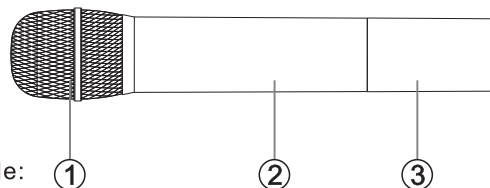

- ⑤ **Power/Mute Switch**

Press and hold to turn the unit on or off. Press and release to mute or unmute the transmitter.

- ⑥ **IR Receiving Section**

This window is used to capture the infrared signal sent from the receiver during the IRUP/DOWN to channelize the transmitter.

## 5. METAL HANG MIC

- ① **Status indicator**

This LED displays the operation mode:

|              |                  |
|--------------|------------------|
| GREEN        | Normal Operation |
| RED          | Mute             |
| Flashing RED | Low power        |

- ② **Power/Mute Switch**

Press and hold to turn the unit on or off. Press and release to mute or unmute the transmitter.

- ③ **Battery Cover**

Unscrew the battery cover and slide down to open the MIC battery compartment

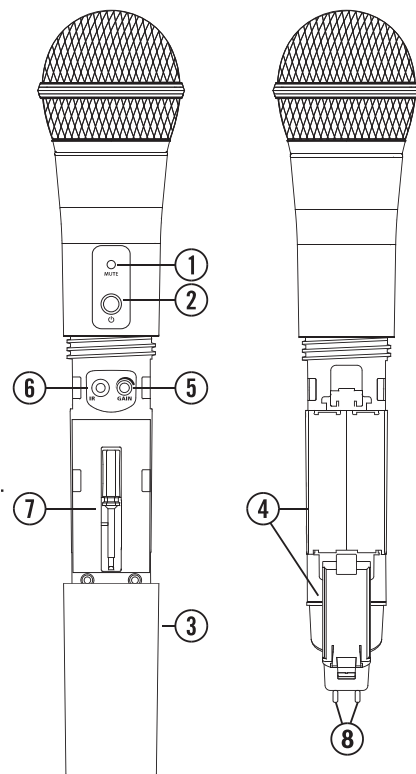

- ④ **Battery Holder**

Open the battery holder by pressing the tab and lifting the cover, insert two standard AA(LR6) batteries here, being sure to observe the plus and minus polarity markings shown. Although rechargeable Ni-Cad batteries can be used, they do not supply adequate current for more than four hours. WARNING: Do not insert the batteries backwards; doing so can cause severe damage to the MIC and will void your warranty.

- ⑤ **Input GAIN Control**

This control adjusts the transmitter input sensitivity. For optimal performance, using the included screwdriver, set the input GAIN control to where you can see the RF display of receiver screen become full light, then turn down until the RF display not full light (less than five).

- ⑥ **IR Lens**

This window is used to capture the infrared signal sent from the receiver during the IR UP/DOWN to channelize the transmitter. The battery cover must be open and the IR Lens facing towards the receiver to load the selected channel.

- ⑦ **Plastic Screwdriver**

Designed for adjusting the MIC input GAIN (See #5 Input GAIN Control HH).

- ⑧ **Charging indicator LED**

lights red when charging and lights green after fully charged.

## 6. BELTPACK MIC

- ① **Antenna**

This permanently attached transmitter antenna should be fully extended during normal operation.

- ② **Status Indicator**

This LED displays the operation mode:

|              |                  |
|--------------|------------------|
| GREEN        | Normal Operation |
| RED          | Mute             |
| Flashing RED | Low power        |

- ③ **Power/Mute Switch**

Press and hold to turn the unit on or off. Press and release to mute or unmute the transmitter.