



# POWERFUL STRAIGHT HORN INSTRUCTION MANUAL

## TH-120

### 1. INSTALLATION PRECAUTIONS

- According to the way of installation (Figure 2), install TU/TU-XXML/MT series driver units separately on the TH-120 DRIVER UNIT Adaptor.
- Install the speaker as shown in Figure 1 and take care that rain water does not enter the driver unit from the front of the speaker. Hanging the speaker as shown in Figure 3 or installing it sideways could cause rain water to collect inside the driver unit, resulting in speaker failure.
- When facing the speaker upward, its mounting angle must be less than 10°. Exceeding this limit could cause rain water to collect inside the horn and no sound could be output.
- When mounting two driver units to the TH-120, make sure that both units are of the same model number. If they differ in model number or power handling capacity, sound interference may occur, resulting in distorted sound or, at worst, speaker failure.

[Figure 1]

Separately-arranged mounting bracket

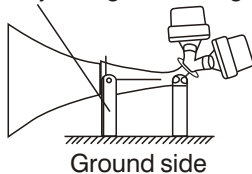

[Figure 2]

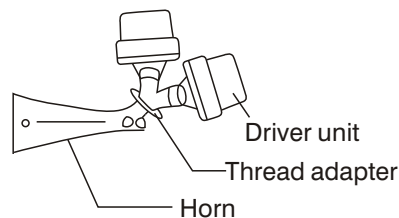

[Figure 3]

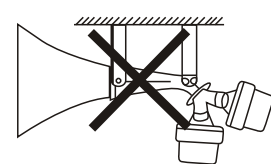

### 2. ASSEMBLY

The following figure applies to the assembly of both the TH-120.

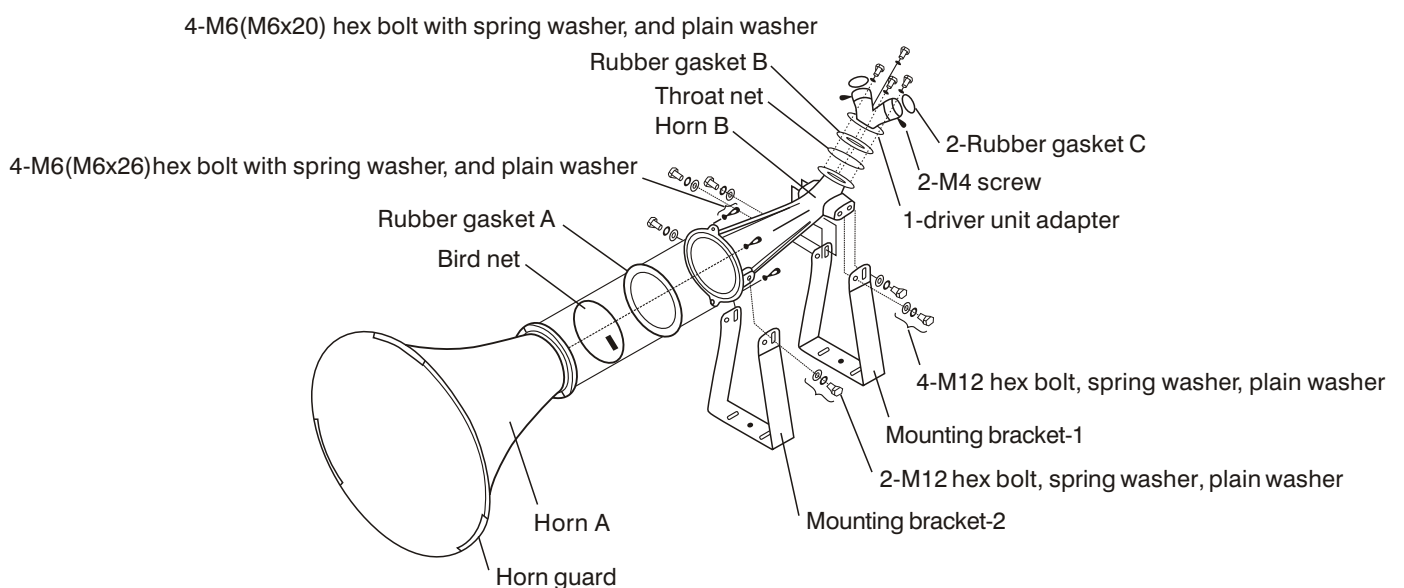

### 3. DIMENSIONAL DIAGRAM

TH-120

Unit: mm

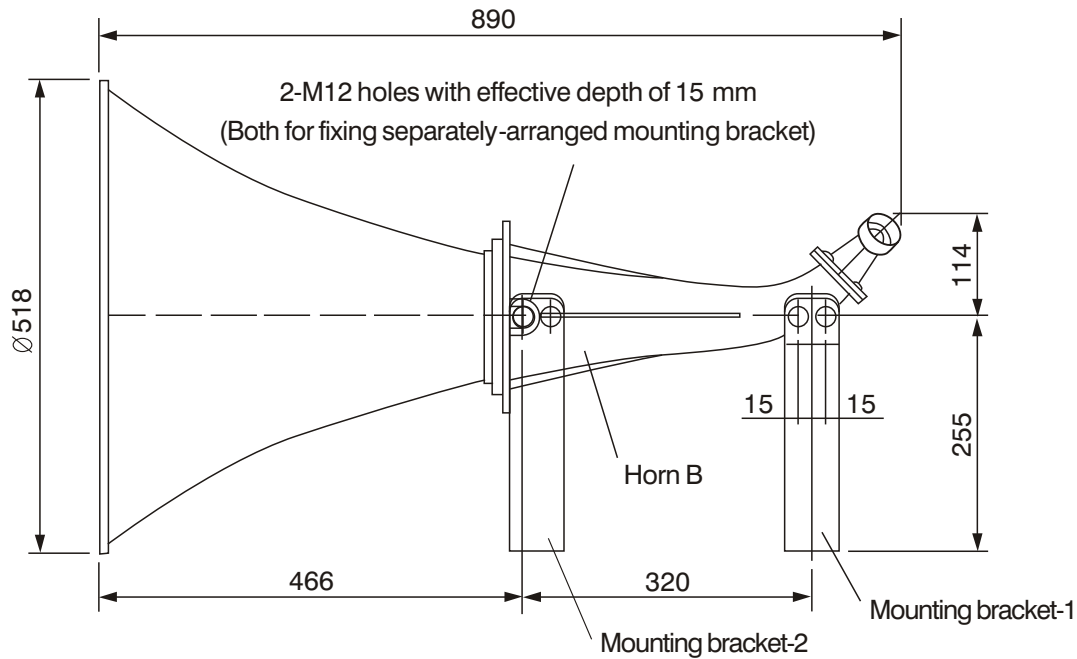

[Horn B dimension]

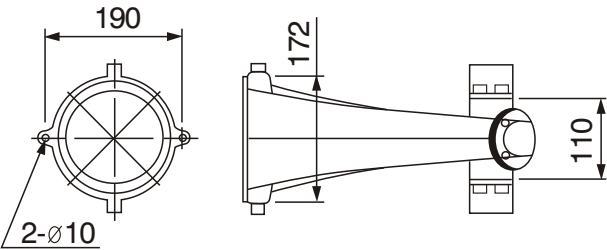

[Dimensions of bracket mounting holes]

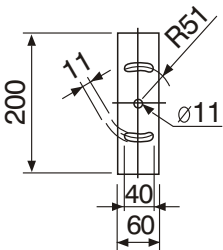

### 4. EQUIPMENT CONFIGURATION

Speaker Model No.	TH-120	Quantity
Parts to make up the component	M6(M6x20) hex bolt with spring washer, and plain washer	4 each (stainless steel)
	Rubber gasket B	1
	Throat net	1
	Horn B	1
	M6(M6x26) hex bolt with spring washer, and plain washer	4 each (stainless steel)
	Rubber gasket A	1
	Bird net	1
	Rubber gasket C	2
	M4 screw	2
	driver unit adapter	1
	M12 hex bolt, spring washer, plain washer	6 each (stainless steel)
	Mounting bracket-1	1
	Mounting bracket-2	1
	Horn A	1
	Horn guard	1

### 5. SPECIFICATIONS

Material	Aluminum
Dimension	$\varnothing 518 \times 890$ mm
Weight(Approx.)	5.8 kg (12.80lb)